

Torggler

Silicone Sealant

UNIVERSAL

PROFESSIONAL

Neutral curing silicone sealant with anti-mould agent, for door and window frames, sanitary use and applications on marble and natural stone.

- Stain-resistant
- High resistance to UV rays
- Colour compatible with Torggler Tile Grouts
- 30 colours

FEATURES

Universal is a neutral curing silicone sealant for use in bathroom installations, and is formulated for use on marble and natural stone substrates as it prevents the onset of the rings caused by the organic plasticisers contained in standard silicone sealants.

With its exceptional resistance to UV rays, atmospheric agents and aging and with its excellent adhesive qualities as well as its great elasticity, it is also suitable for use in the sector of door and window frames (both inside and outside), and as a sealant for the perimeter joint between the frame and the wall as well as for the sealing of the joint between the glass and fixture frame (in compliance with UNI 11673-1, "Fitting door and window frames – Part 1: requirements and criteria for verification of design").

Furthermore the low modulus of elasticity means Universal can be used as a sealant between components utilised for both internal and external facades. The polymerisation process does not produce acidic or basic substances that can attack metal substrates. Universal is classified as a non-structural sealant for facade elements for external and internal use (F-EXT/INT in compliance with EN 15651-1), for glazing (G according to EN 15651-2) and for sanitary uses (XS according to EN 15651-3).

APPLICATION RANGE

Universal is ideal for:

- Seals between glass and frame (metal, pre-painted, wood or plastic);
- Joint seals for connections between frame and wall (masonry, concrete, plaster).
- Joint sealing for internal and external facade parts.
- Waterproof seals, also mould-resistant, on the connection joints in sanitary environments (bathrooms, tubs, shower booths, wash basins, SPA environments and pools).
- Seals on marble and natural stone.



INSTRUCTIONS FOR USE

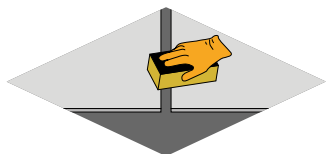

- 1.**
The sides of the joint must be clean, degreased and dry. With porous substrates it is recommended to first treat with Silicon Primer. With deep dilation joints pad with rigid shaped foam elements before sealing.

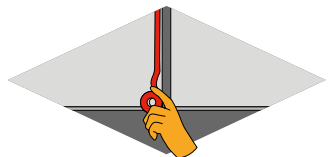

- 2.**
Apply adhesive tape along the sides of the joint.

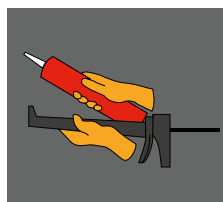

- 3.**
Insert the cartridge in the application gun, open it, screw on the spout and cut off the tip to obtain a sufficient aperture.

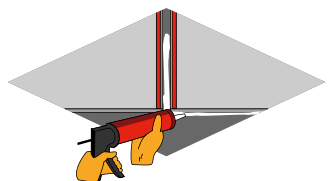

- 4.**
Extrude an abundant quantity of sealant.

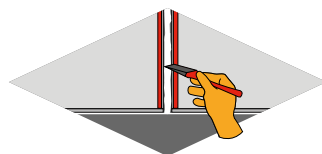

- 5.**
Smooth off with a damp paint scraper within 5 minutes of application, exerting enough pressure to remove any air bubbles.

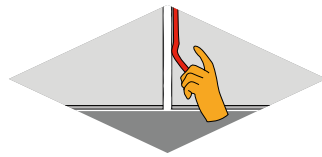

- 6.**
Remove the adhesive tape immediately after smoothing.

SIZING OF THE JOINT

Minimum width = 6 mm. For joint widths of less than 10 mm, the depth must be equal to the width of the joint and in any case not less than 6 mm. For joint widths between 10 mm and 20 mm the depth must be at least 10 mm. For widths larger than 20 mm the depth must be at least half of the width.

CLEANING OF TOOLS

While the sealant is in the plastic state use solvents; following setting clean only mechanically.

OBSERVATIONS

Universal is not suitable for structural bonding. Universal does not adhere to Teflon, polyethylene, polypropylene, as well as on damp substrates. Universal cannot be painted over.

TECHNICAL SPECIFICATIONS

PARAMETER AND TEST METHOD	VALUE
Density (ISO 1183-1):	1,02 g/ml
Application temperature:	from +5 °C to +40 °C
Skin-over time (MIT 33*):	approx. 20 minutes
Hardening rate from the outside to the inside at 23 °C (MIT 32*):	approx. 2,4 mm in 24 h
Operating temperature:	from -30 °C to +150 °C
Surface hardness (ISO 868):	Shore A: max = 25 /15'' = 18
Elongation at break (DIN 53504 - Punch S3):	approx. 700 %
Modulus of elasticity at 100% (DIN 53504 - Punch S3)	approx. 0,4 N/mm ²
Tensile strength at break (DIN 53504 - Punch S3):	approx. 1,00 N/mm ²
Elongation at break (EN ISO 8339/A)	130 %
Modulus of elasticity at 100% (DIN 53504 -Punch S3):	0,35 N/mm ²
Tensile strength at break (EN ISO 8339/A)	0,4 N/mm ²
Elastic recovery (EN ISO 7389/B)	> 90 %
Creep resistance (EN ISO 7390)	0,0 mm
Maximum operating elongation (ISO 11600)	25 %
Acid resistance:	Excellent
Base resistance:	Excellent
Odour after curing:	None

* Torggler Internal Methods (MIT) are available on request.

JOINT WIDTH X DEPTH (MM)	COVERAGE GUIDE TABLE	
	QUANTITY USED PER LINEAR METRE	LINEAR METRES COVERED WITH ONE CARTRIDGE
6x6	36 ml	8,7
8x8	64 ml	4,9
10x10	100 ml	3,1
15x10	150 ml	2,1
20x10	200 ml	1,6
30x15	450 ml	0,7

STORAGE

Universal must be stored in a cool, dry place. Stored in these conditions the product will keep for at least 12 months. Partly used cartridges can be stored for approx. 3 months provided they are tightly closed.

PACKAGING

310 ml cartridges

COLOUR RANGE

	Transparent		Emerald green		Green
	White		Ruby		Cement grey
	Manhattan		Mint		Anthracite
	Pearl grey		Crocus		Chestnut
	Jasmin		Blue		Black
	Bahama Beige		Ocean		Light brown
	Magnolia		Purple		Chocolate
	Terracotta		Dark blue		Cherry
	Brown		Yellow		Douglas
	Caramell		Red		Oak



Torggler Chimica S.p.A., Via Verande 1/A, I – 39012 Merano (BZ)

14

DoP n° 072/14

NB n° 0432

EN 15651-1:2012 / EN 15651-2:2012 / EN 15651-3:2012

Silicone Universal: Sealant for facade for interior and exterior application ;
Sealant for glazing ; Sealant for joints in sanitary areas

EN 15651-1: F-EXT/INT

EN 15651-2: G

EN 15651-3: XS

Conditioning: ISO 8339/A

Substrate: M_{1 p} (Primer Silicon), G

Reacton to fire	F	
Release of dangerous substances	NPD	
Water tightness and air tightness	Resistance to flow	≤ 5 mm
	Loss of volume	≤ 45 %
	Tensile properties at maintained extension at 23 °C	NF
	Tensile properties at maintained extension after immersion in water at 23 °C	NF
	Elastic recovery	≥ 40 %
	Tensile properties after exposure to heat, water and artificial light	NF
Microbiological growth	0	
Durability	Passed	

CERTIFICATIONS

The declarations of performance (DoP) are available on request.

LEGENDA FOR CLASSIFICATION ACCORDING TO EN 15651

F	Sealant for non-structural joints for the building trade, on facades. (F = facade elements)
INT	Sealant for internal use only.
EXT-INT	Sealant for internal and external use.
CC	Sealant tested for cold climates. (CC = cold climate - testing done at -30 °C)
G	Sealant for non-structural joints on glazing and door and window frames. (G = glazing)
S	Sealant for non-structural joints in bathroom installations. (S = sanitary joints)
XS	Sealant for joints in bathroom installations with improved performance.
PW	Sealant for non-structural joints on pedestrian walkways. (PW = pedestrian walkways)

To the best of our knowledge the information given in this document is true and accurate. However, since we have no direct control over the actual conditions of use, our recommendations and suggestions are provided as a guide only and do not constitute a guarantee. If you have any doubts we recommend that you test the product before use or contact our specialists for further advice. Torggler Chimica S.p.A. reserves the right to change, substitute or delete items or otherwise make variations to the product data in this document without prior notice. It is possible therefore that the information given in this document is no longer valid. This document substitutes the previous version. Version 09.2018.